

# ARRIVAL PROCEDURE

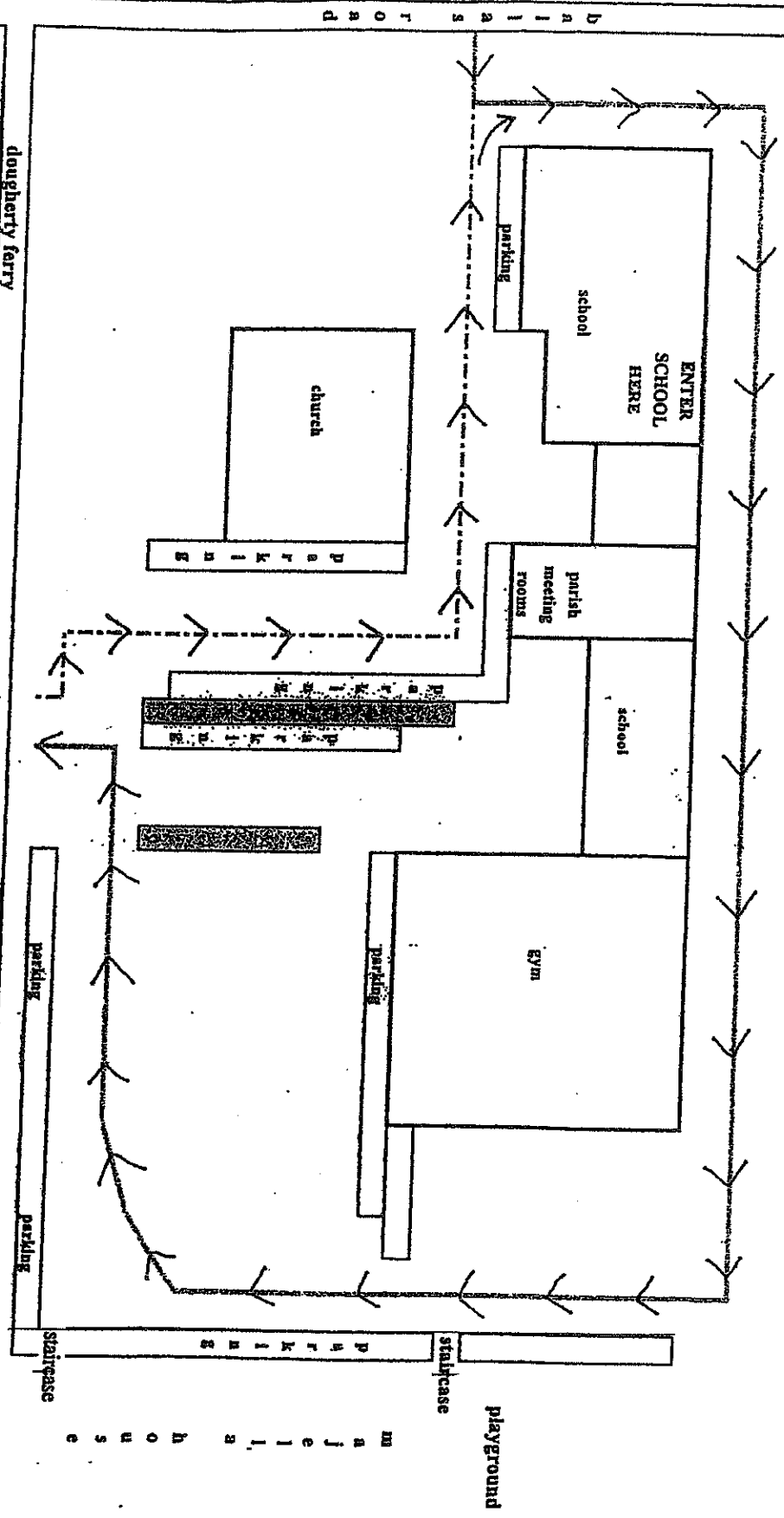

- Enter the lot from Ballas Road and drive around the back of the building driving from west to east
- If you enter the lot from Dougherty Ferry, make a left driving past Church.
  - Meld into the line of cars entering from Ballas and continue around the back of the building driving from west to east
- Drive up to indicated sign (staff will be on duty to direct traffic and monitor children)
- Children exit from the passenger side of your car and enter building directly into Liguori Hall (new cafeteria area)
- Continue to drive around the back of the school building and exit on Dougherty Ferry
- Staff will be on duty at that door until the 7:50am pager rings (ardy bell). If you do not see staff at the door, circle around to the main entrance of school, park, bring your child(ren) into school, and sign them in

# DISMISSAL PROCEDURE

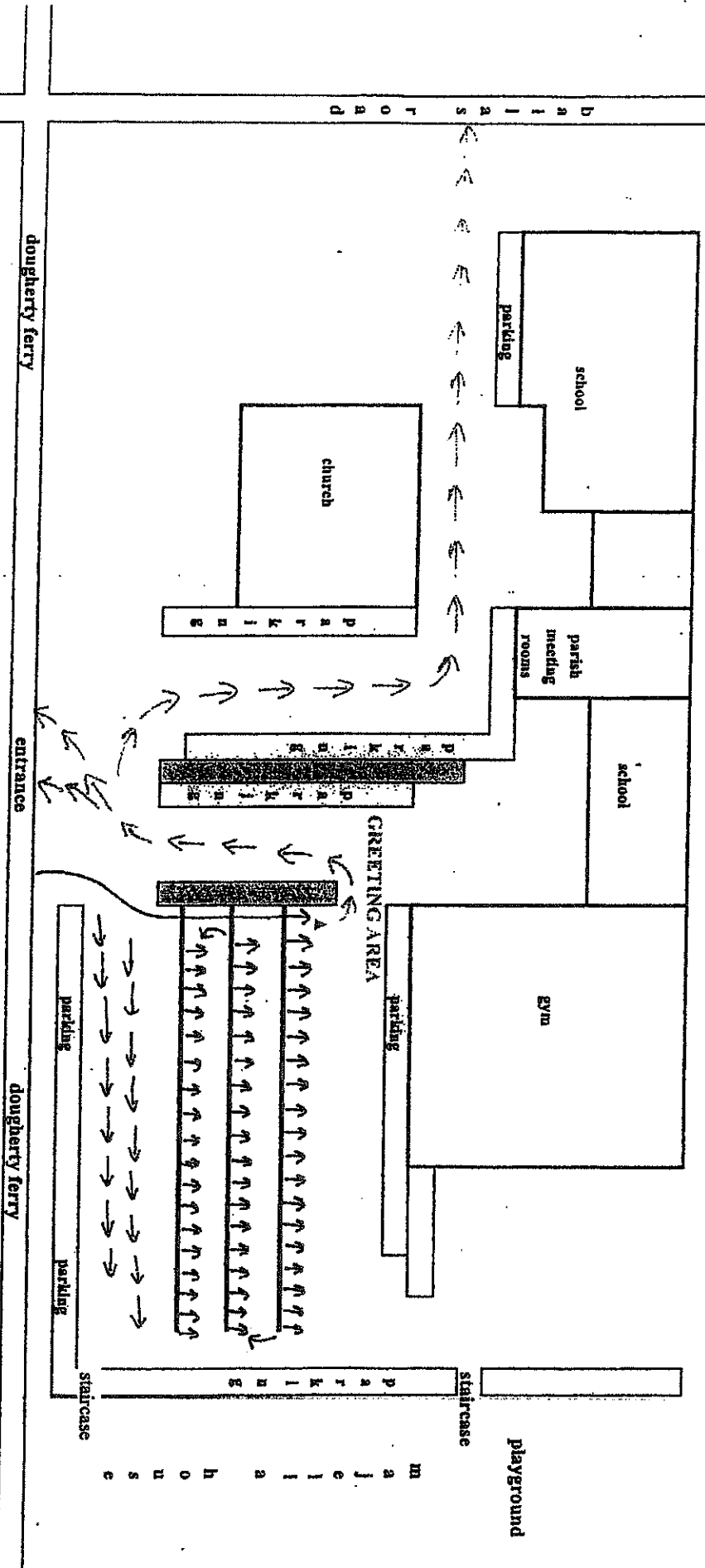

- Enter the lot from Dougherty Ferry, turn right, and park facing the gym pulling up to the spot indicated by the black triangle.
- After the first car is in place, park as close to the next car as is reasonable. Parent carpool workers will direct you.
- As the three main rows of parking fill up, you will then be directed by parent carpool workers to two additional rows of horizontal parking.
- Homeroom teachers of ALL grade levels walk their classes to the greeting area to meet you or proceed immediately to cars.
- A signal will be given by carpool workers. Any children not in cars will be held in the greeting area under teacher supervision.
- Cars will then be directed to exit onto either Dougherty Ferry or Ballas Road.